

Wafer 1.25 mm

CAE125 Series

SPECIFICATIONS

Current Rating: 1 A, AC/DC
 Voltage Rating: 200 V AC/DC
 Temperature Range: -25°C ~ +85 °C
 Contact Resistance: 20 mOhm max.
 Insulator Resistance: 100 MOhm min.
 Withstanding Voltage: AC 500 V / minute
 Finished: Tin-plated / Gold-plated
 Housing Material: Nylon-66, UL 94V-0

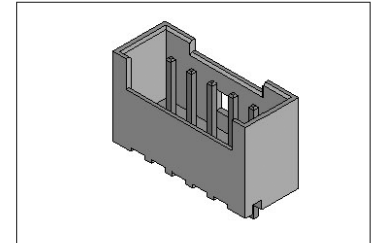
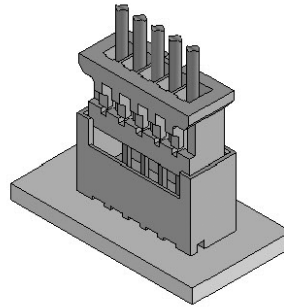

Number of
Contacts

CCAE -W125 - XX



(02 TO 15
Contacts)

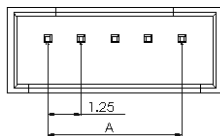

P.C.B LAYOUT

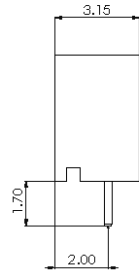
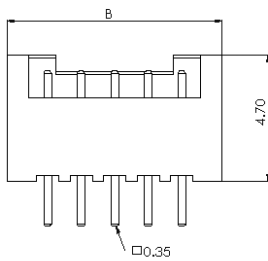

Circuits	Dimension mm		Circuits	Dimension mm	
	A	B		A	B
2PIN	1.25	4.25	9PIN	10.00	13.00
3PIN	2.50	5.50	10PIN	11.25	14.25
4PIN	3.75	6.75	11PIN	12.50	15.50
5PIN	5.00	8.00	12PIN	13.75	16.75
6PIN	6.25	9.25	13PIN	15.00	18.00
7PIN	7.50	10.50	14PIN	16.25	19.25
8PIN	8.75	11.75	15PIN	17.50	20.50

Unit: mm

SPECIFICATIONS

Current Rating: 1 A, AC/DC
 Voltage Rating: 200 V AC/DC
 Temperature Range: -25°C ~ +85 °C
 Contact Resistance: 20 mOhm max.
 Insulator Resistance: 100 MOhm min.
 Withstanding Voltage: AC 500 V / minute
 Finished: Tin-plated / Gold-plated
 Housing Material: Nylon-66, UL 94V-0

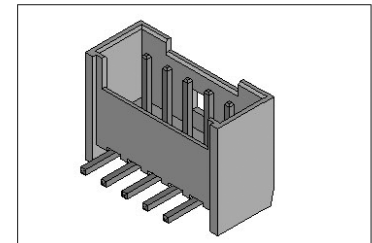
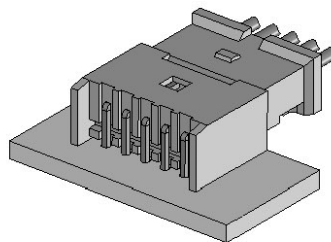

Connector
Type

Number of
Contacts

CCAE -W125 R - XX



R: Right Angle (02 TO 15
Contacts)

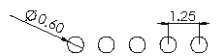
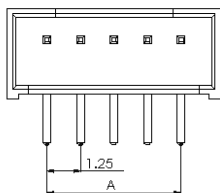

P.C.B LAYOUT

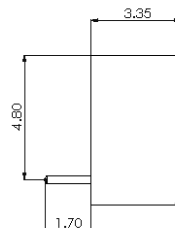
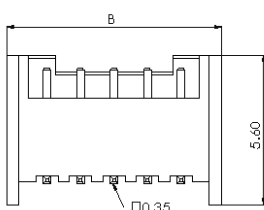

Circuits	Dimension mm		Circuits	Dimension mm	
	A	B		A	B
2PIN	1.25	4.25	9PIN	10.00	13.00
3PIN	2.50	5.50	10PIN	11.25	14.25
4PIN	3.75	6.75	11PIN	12.50	15.50
5PIN	5.00	8.00	12PIN	13.75	16.75
6PIN	6.25	9.25	13PIN	15.00	18.00
7PIN	7.50	10.50	14PIN	16.25	19.25
8PIN	8.75	11.75	15PIN	17.50	20.50

Unit: mm